

BAN02**Four full Wave Dipole
Panel Antenna****174÷230 MHz**

Type	BAN02
Frequency	174÷230 MHz
Impedance	50 Ω
V.S.W.R.	≤ 1.10
Gain	10.8 dBd
HPBW	
E-plane	$\pm 28^\circ$
H-plane	$\pm 12.5^\circ$
Polarization	Horizontal
Input connector	7/8" EIA flange
option 1	7/16 female
Max power	2 kW with 7/8" EIA flange
Survival wind velocity	180 km/h
Wind load at 160 km/h	
Frontal	1159 N
Lateral	162 N
Dimensions	290x126x63 cm
Packing type	wooden crate
dimensions	294x130x68 cm
Net weight	75 kg
Gross weight	125 kg

**RADIATION PATTERN**

H_plane

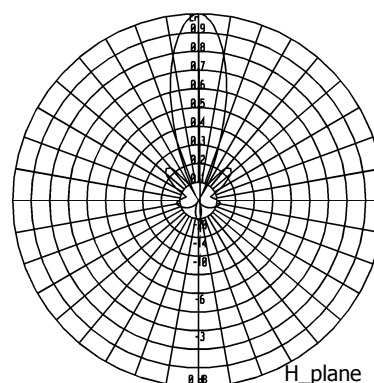
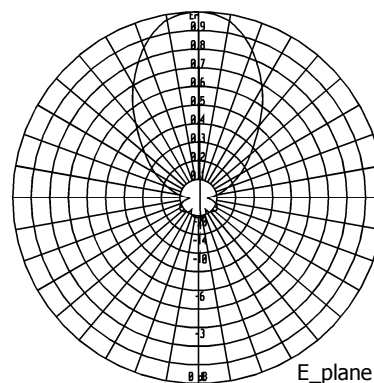

E_plane

The reflector is made of hot deep galvanised steel, while radiating elements, as well as nuts and screws, are made of stainless steel.

All metallic parts are connected to the ground.

Each antenna is sealed and pressurisable.

Input connector is nickel plated while internal lines are made of silver plated brass.

Also available a dismantable version.

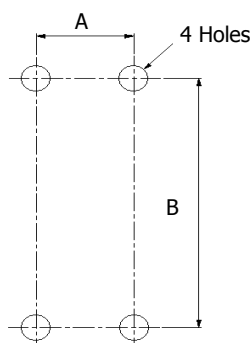
**MOUNTING SYSTEM**

On frame according to the mounting lay-out beside, where:

A = 80 mm

B = 800 mm

C = 17 mm

Pole mount available on request.

These panels can be used in horizontal polarization to set up systems having directive, semidirective and omnidirectional diagrams.

Systems made up with 02 panels can be designed on customer specifications.