



ADAPTERS

---

ADATTATORI

---

## 4.1/9.5 MALE/MASCHIO - N FEMALE/FEMMINA

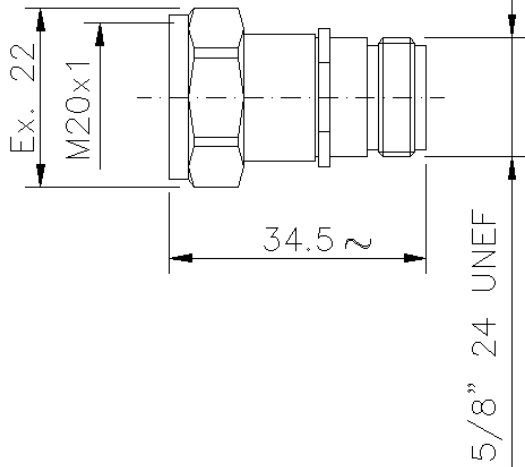
	<p><b>Materials/Materiali</b> <span style="float: right;"><b>BELCO P/N</b></span>  <b>Body nuts and other metal part/Corpo ghiera e altre parti metalliche:</b>  Brass/Ottone  <b>4.1/9.5 Contact/Contatto 4.1/9.5:</b>  Brass/Ottone  <b>N Contact/ Contatto N:</b>  CuBe  <b>Insulator/Isolante:</b>  PTFE  <b>Gaskets/Guarnizioni:</b>  Silicone Rubber/Gomma Siliconica  <b>Finishing/Finiture</b>  <b>Body/Corpo:</b>  Ag 5µm min.  <b>Contacts/Contatti:</b>  Ag 5µm min.  <b>Other metallic parts/Altre parti metalliche:</b> Ni 5µm min.</p> <p style="text-align: right;"><b>0175</b></p>
---	--

## 4.1/9.5 FEMALE/FEMMINA - N FEMALE/FEMMINA

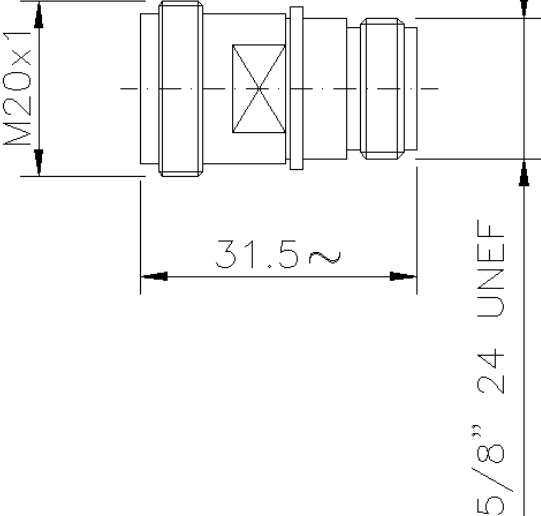
	<p><b>Materials/Materiali</b> <span style="float: right;"><b>BELCO P/N</b></span>  <b>Body nuts and other metal part/Corpo ghiera e altre parti metalliche:</b>  Brass/Ottone  <b>4.1/9.5 Contact/Contatto 4.1/9.5:</b>  CuBe  <b>N Contact/ Contatto N:</b>  CuBe  <b>Insulator/Isolante:</b>  PTFE  <b>Gaskets/Guarnizioni:</b>  Silicone Rubber/Gomma Siliconica  <b>Finishing/Finiture</b>  <b>Body/Corpo:</b>  Ag 5µm min.  <b>Contacts/Contatti:</b>  Ag 5µm min.  <b>Other metallic parts/Altre parti metalliche:</b> Ni 5µm min.</p> <p style="text-align: right;"><b>0174</b></p>
---	--

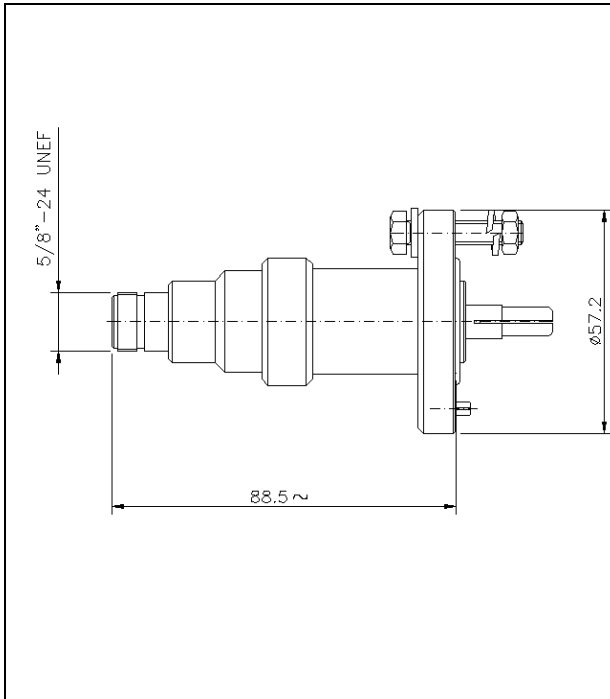
**N FEMALE/FEMMINA - EIA 7/8"**

**Materials/Materiali**  
**Body nuts and other metal part/Corpo ghiera e altre parti metalliche:**  
 Brass/Ottone  
**7/8 Contact/Contatto 7/8:**  
 Brass/Ottone  
**N Contact/ Contatto N:**  
 CuBe  
**Insulator/Isolante:**  
 PTFE  
**Gaskets/Guarnizioni:**  
 Silicone Rubber/Gomma Siliconica  
**Finishing/Finiture**  
**Body/Corpo:**  
 Ag 5µm min.  
**Contacts/Contatti:**  
 Ag 5µm min.  
**Other metallic parts/Altre parti metalliche:** Ni 5µm min.

**BELCO P/N**  
**0118**

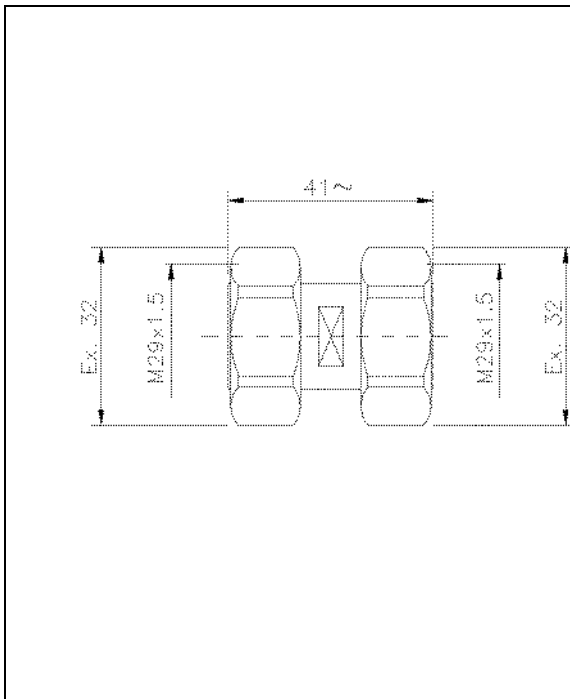
**7/16 MALE/MASCHIO - 7/16 MALE/MASCHIO**

**Materials/Materiali**  
**Body nuts and other metal part/Corpo ghiera e altre parti metalliche:**  
 Brass/Ottone  
**7/16 Contact/Contatto 7/16:**  
 Brass/Ottone  
**7/16 Contact/ Contatto 7/16:**  
 Brass/Ottone  
**Insulator/Isolante:**  
 PTFE  
**Gaskets/Guarnizioni:**  
 Silicone Rubber/Gomma Siliconica  
**Finishing/Finiture**  
**Body/Corpo:**  
 Ag 5µm min.  
**Contacts/Contatti:**  
 Ag 5µm min.  
**Other metallic parts/Altre parti metalliche:** Ni 5µm min.

**BELCO P/N**  
**0123**

## 7/16 MALE/MASCHIO - N MALE/MASCHIO

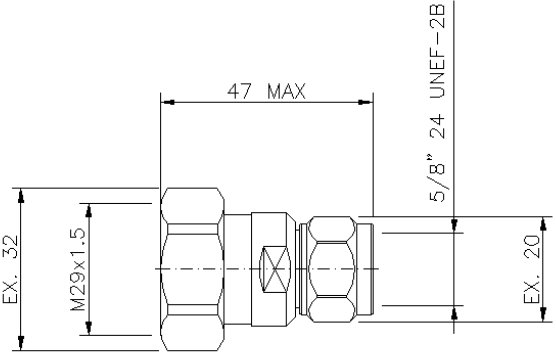
	<p><b>Materials/Materiali</b>  <b>Body nuts and other metal part/Corpo ghiera e altre parti metalliche:</b>          Brass/Ottone  <b>7/16 Contact/Contatto 7/16:</b>          Brass/Ottone  <b>N Contact/ Contatto N:</b>          Brass/Ottone  <b>Insulator/Isolante:</b>          PTFE  <b>Gaskets/Guarnizioni:</b>          Silicone Rubber/Gomma Siliconica  <b>Finishing/Finiture</b>  <b>Body/Corpo:</b>          Ag 5µm min.  <b>Contacts/Contatti:</b>          Ag 5µm min.  <b>Other metallic parts/Altre parti metalliche:</b> Ni 5µm min.</p>
---	--

**BELCO P/N**  
**0124**

## 7/16 MALE/MASCHIO - N FEMALE/FEMMINA

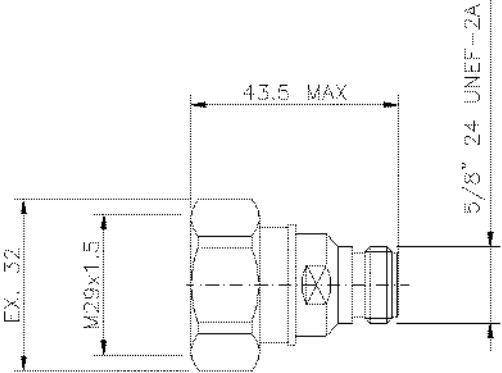
	<p><b>Materials/Materiali</b>  <b>Body nuts and other metal part/Corpo ghiera e altre parti metalliche:</b>          Brass/Ottone  <b>7/16 Contact/Contatto 7/16:</b>          Brass/Ottone  <b>N Contact/ Contatto N:</b>          CuBe  <b>Insulator/Isolante:</b>          PTFE  <b>Gaskets/Guarnizioni:</b>          Silicone Rubber/Gomma Siliconica  <b>Finishing/Finiture</b>  <b>Body/Corpo:</b>          Ag 5µm min.  <b>Contacts/Contatti:</b>          Ag 5µm min.  <b>Other metallic parts/Altre parti metalliche:</b> Ni 5µm min.</p>
---	--

**BELCO P/N**  
**0125**

## 7/16 MALE/MASCHIO - EIA 7/8"

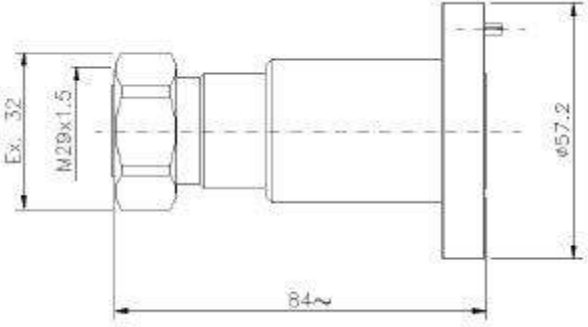
 <p>Technical drawing of a 7/16 MALE/MASCHIO - EIA 7/8" adapter. The drawing shows a side view of the component with dimensions: Ex. 32 (total length), M29x1.5 (thread), 84 (main body length), and ø57.2 (outer diameter).</p>	<p><b>Materials/Materiali</b>  <b>Body nuts and other metal part/Corpo ghiera e altre parti metalliche:</b>          Brass/Ottone  <b>7/8 Contact/Contatto 7/8:</b>          Brass/Ottone  <b>4/16 Contact/ Contatto 7/16:</b>          Brass/Ottone  <b>Insulator/Isolante:</b>          PTFE  <b>Gaskets/Guarnizioni:</b>          Silicone Rubber/Gomma Siliconica  <b>Finishing/Finiture</b>  <b>Body/Corpo:</b>          Ag 5µm min.  <b>Contacts/Contatti:</b>          Ag 5µm min.  <b>Other metallic parts/Altre parti metalliche:</b> Ni 5µm min.</p> <p><b>BELCO P/N</b> 0040</p>
---	---

## 90° 7/16 MALE/MASCHIO - 7/16 FEMALE/FEMMINA

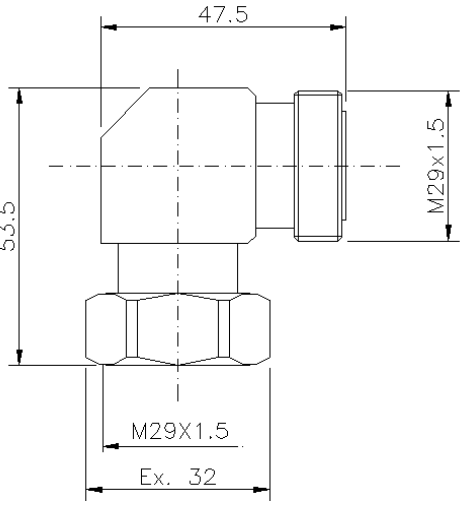
 <p>Technical drawing of a 90° 7/16 MALE/MASCHIO - 7/16 FEMALE/FEMMINA adapter. The drawing shows a side view of the component with dimensions: 47.5 (main body length), 53.5 (total length), M29x1.5 (thread), and Ex. 32 (total length).</p>	<p><b>Materials/Materiali</b>  <b>Body nuts and other metal part/Corpo ghiera e altre parti metalliche:</b>          Brass/Ottone  <b>Male 7/16 Contact/Contatto 7/16 maschio:</b>          Brass/Ottone  <b>Female 7/16 Contact/ Contatto 7/16 Femmina:</b>          CuBe  <b>Insulator/Isolante:</b>          PTFE  <b>Gaskets/Guarnizioni:</b>          Silicone Rubber/Gomma Siliconica  <b>Finishing/Finiture</b>  <b>Body/Corpo:</b>          Ag 5µm min.  <b>Contacts/Contatti:</b>          Ag 5µm min.  <b>Other metallic parts/Altre parti metalliche:</b> Ni 5µm min.</p> <p><b>BELCO P/N</b> 0020</p>
---	---

## 7/16 FEMALE/FEMMINA - 7/16 FEMALE/FEMMINA

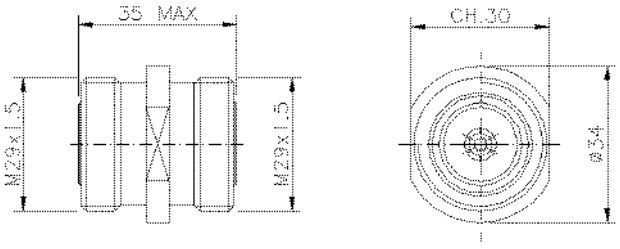
	<p><b>Materials/Materiali</b>  <b>Body nuts and other metal part/Corpo ghiera e altre parti metalliche:</b>          Brass/Ottone  <b>7/16 Contacts/Contatti 7/16:</b>          CuBe  <b>Insulator/Isolante:</b>          PTFE  <b>Gaskets/Guarnizioni:</b>          Silicone Rubber/Gomma Siliconica  <b>Finishing/Finiture</b>  <b>Body/Corpo:</b>          Ag 5µm min.  <b>Contacts/Contatti:</b>          Ag 5µm min.</p>	<p><b>BELCO P/N</b>  <b>0122</b></p>
---	---	--

## PANEL/PANNELLO - 7/16 FEMALE/FEMMINA - 7/16 FEMALE/FEMMINA

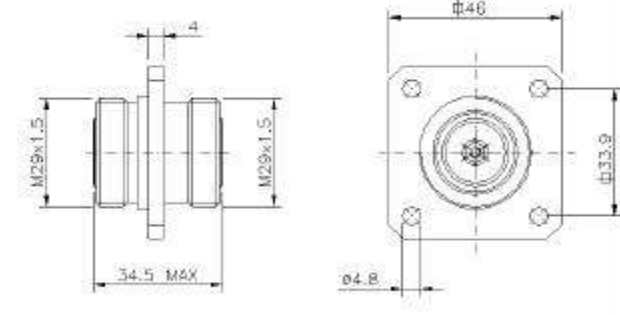
	<p><b>Materials/Materiali</b>  <b>Body nuts and other metal part/Corpo ghiera e altre parti metalliche:</b>          Brass/Ottone  <b>7/16 Contacts/Contatti 7/16:</b>          Brass/Ottone  <b>Insulator/Isolante:</b>          PTFE  <b>Gaskets/Guarnizioni:</b>          Silicone Rubber/Gomma Siliconica  <b>Finishing/Finiture</b>  <b>Body/Corpo:</b>          Ag 5µm min.  <b>Contacts/Contatti:</b>          Ag 5µm min.</p>	<p><b>BELCO P/N</b>  <b>0590</b></p>
--	---	--

## 7/16 FEMALE/FEMMINA - N MALE/MASCHIO

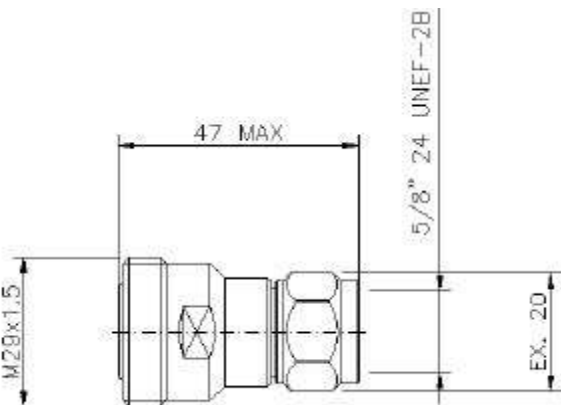
	<p><b>Materials/Materiali</b>  <b>Body nuts and other metal part/Corpo ghiera e altre parti metalliche:</b>          Brass/Ottone  <b>7/16 Contact/Contatto 7/16:</b>          CuBe  <b>N Contact/ Contatto N:</b>          Brass/Ottone  <b>Insulator/Isolante:</b>          PTFE  <b>Gaskets/Guarnizioni:</b>          Silicone Rubber/Gomma Siliconica  <b>Finishing/Finiture</b>  <b>Body/Corpo:</b>          Ag 5µm min.  <b>Contacts/Contatti:</b>          Ag 5µm min.  <b>Other metallic parts/Altre parti metalliche:</b> Ni 5µm min.</p> <p style="text-align: right;"><b>BELCO P/N</b> <b>0126</b></p>
---	---

## 7/16 FEMALE/FEMMINA - N FEMALE/FEMMINA

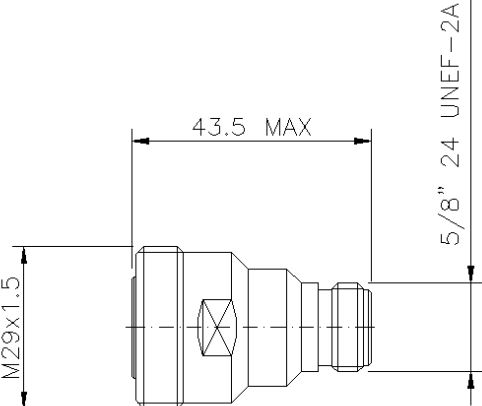
	<p><b>Materials/Materiali</b>  <b>Body nuts and other metal part/Corpo ghiera e altre parti metalliche:</b>          Brass/Ottone  <b>7/16 Contact/Contatto 7/16:</b>          CuBe  <b>N Contact/ Contatto N:</b>          CuBe  <b>Insulator/Isolante:</b>          PTFE  <b>Gaskets/Guarnizioni:</b>          Silicone Rubber/Gomma Siliconica  <b>Finishing/Finiture</b>  <b>Body/Corpo:</b>          Ag 5µm min.  <b>Contacts/Contatti:</b>          Ag 5µm min.</p> <p style="text-align: right;"><b>BELCO P/N</b> <b>0127</b></p>
---	--

## 7/16 FEMALE/FEMMINA - EIA 7/8"

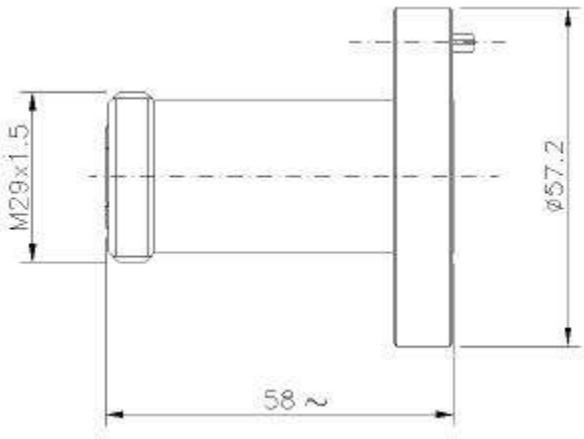
	<p><b>Materials/Materiali</b>  <b>Body nuts and other metal part/Corpo ghiera e altre parti metalliche:</b>          Brass/Ottone  <b>7/8 Contact/Contatto 7/8:</b>          Brass/Ottone  <b>7/16 Contact/ Contatto 7/16:</b>          CuBe  <b>Insulator/Isolante:</b>          PTFE  <b>Gaskets/Guarnizioni:</b>          Silicone Rubber/Gomma Siliconica  <b>Finishing/Finiture</b>  <b>Body/Corpo:</b>          Ag 5µm min.  <b>Contacts/Contatti:</b>          Ag 5µm min.  <b>Other metallic parts/Altre parti metalliche:</b> Ni 5µm min.</p>	<p><b>BELCO P/N</b>  <b>0128</b></p>
---	--	--

## 7/16 FEMALE/FEMMINA - 13/30 MALE/MASCHIO

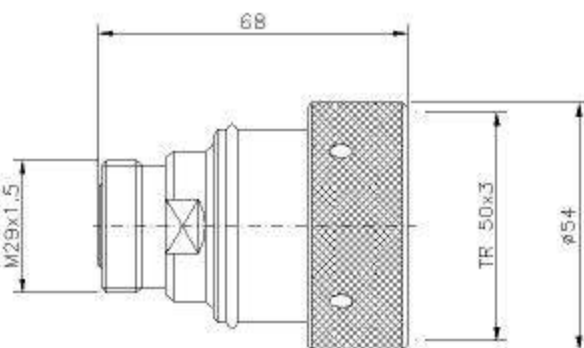
	<p><b>Materials/Materiali</b>  <b>Body nuts and other metal part/Corpo ghiera e altre parti metalliche:</b>          Brass/Ottone  <b>7/16 Contact/Contatto 7/16:</b>          Brass/Ottone  <b>13/30 Contact/ Contatto 13/30:</b>          Brass/Ottone  <b>Insulator/Isolante:</b>          PTFE  <b>Gaskets/Guarnizioni:</b>          Silicone Rubber/Gomma Siliconica  <b>Finishing/Finiture</b>  <b>Body/Corpo:</b>          Ag 5µm min.  <b>Contacts/Contatti:</b>          Ag 5µm min.  <b>Other metallic parts/Altre parti metalliche:</b> Ni 5µm min.</p>	<p><b>BELCO P/N</b>  <b>0580</b></p>
---	--	--

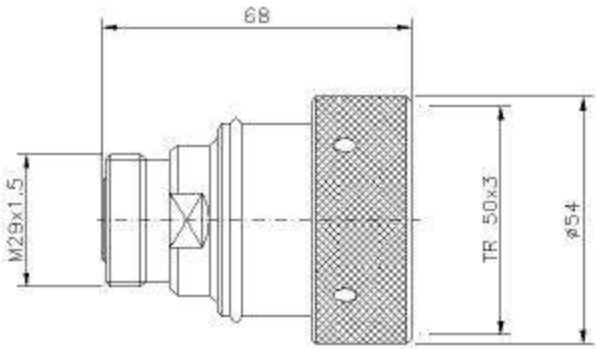

## 7/16 FEMALE/FEMMINA - 13/30 MALE/MASCHIO

	<p><b>Materials/Materiali</b>  <b>Body nuts and other metal part/Corpo ghiera e altre parti metalliche:</b>          Brass/Ottone  <b>7/16 Contact/Contatto 7/16:</b>          CuBe  <b>13/30 Contact/ Contatto 13/30:</b>          Brass/Ottone  <b>Insulator/Isolante:</b>          PTFE  <b>Gaskets/Guarnizioni:</b>          Silicone Rubber/Gomma Siliconica  <b>Finishing/Finiture</b>  <b>Body/Corpo:</b>          Ag 5µm min.  <b>Contacts/Contatti:</b>          Ag 5µm min.  <b>Other metallic parts/Altre parti metalliche:</b> Ni 5µm min.</p> <p style="text-align: right;"><b>BELCO P/N</b> 0580</p>
---	--

## 7/16 FEMALE/FEMMINA - EIA 1"-5/8

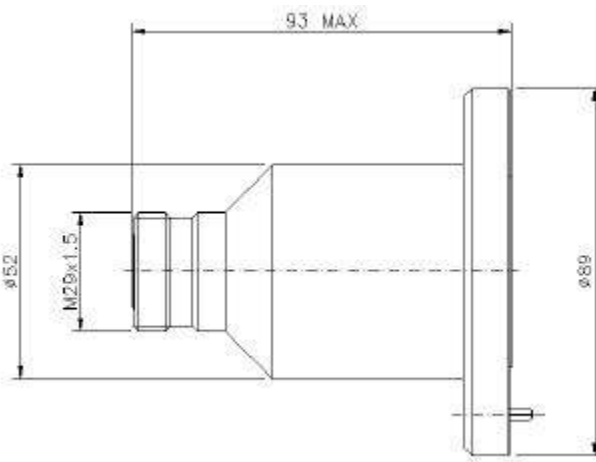
	<p><b>Materials/Materiali</b>  <b>Body nuts and other metal part/Corpo ghiera e altre parti metalliche:</b>          Brass/Ottone  <b>7/16 Contact/Contatto 7/16:</b>          CuBe  <b>1-5/8 Contact/ Contatto 1-5/8:</b>          Brass/Ottone  <b>Insulator/Isolante:</b>          PTFE  <b>Gaskets/Guarnizioni:</b>          Silicone Rubber/Gomma Siliconica  <b>Finishing/Finiture</b>  <b>Body/Corpo:</b>          Ag 5µm min.  <b>Contacts/Contatti:</b>          Ag 5µm min.  <b>Other metallic parts/Altre parti metalliche:</b> Ni 5µm min.</p> <p style="text-align: right;"><b>BELCO P/N</b> 0591</p>
---	--

## 13/30 MALE/MASCHIO - 13/30 MALE/MASCHIO

	<p><b>Materials/Materiali</b> <span style="float: right;"><b>BELCO P/N</b></span>  <b>Body nuts and other metal</b> <span style="float: right;"><b>0584</b></span>  <b>part/Corpo ghiera e altre parti</b>  <b>metalliche:</b>      Brass/Ottone  <b>Contacts/Contatti:</b>      Brass/Ottone  <b>Insulator/Isolante:</b>      PTFE  <b>Gaskets/Guarnizioni:</b>      Silicone Rubber/Gomma Siliconica  <b>Finishing/Finiture</b>  <b>Body/Corpo:</b>      Ag 5µm min.  <b>Contacts/Contatti:</b>      Ag 5µm min.  <b>Other metallic parts/Altre</b>  <b>parti metalliche:</b> Ni 5µm min.</p>
--	---

## 13/30 FEMALE/FEMMINA - 13/30 FEMALE/FEMMINA

	<p><b>Materials/Materiali</b> <span style="float: right;"><b>BELCO P/N</b></span>  <b>Body nuts and other metal</b> <span style="float: right;"><b>0581</b></span>  <b>part/Corpo ghiera e altre parti</b>  <b>metalliche:</b>      Brass/Ottone  <b>Contacts/Contatti:</b>      CuBe  <b>Insulator/Isolante:</b>      PTFE  <b>Gaskets/Guarnizioni:</b>      Silicone Rubber/Gomma Siliconica  <b>Finishing/Finiture</b>  <b>Body/Corpo:</b>      Ag 5µm min.  <b>Contacts/Contatti:</b>      Ag 5µm min.</p>
--	--

**PANEL/PANNELLO - 13/30 FEMALE/FEMMINA - 13/30 FEMALE/FEMMINA**

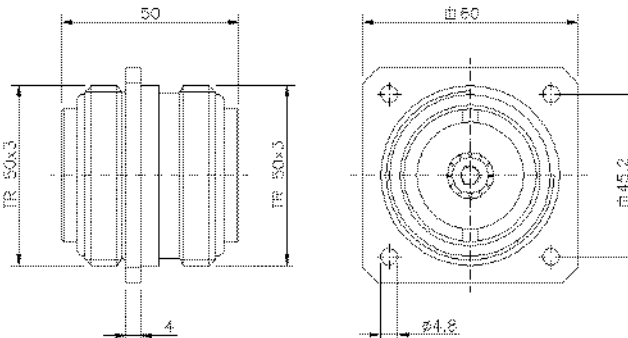
	<p><b>Materials/Materiali</b> <b>BELCO P/N</b>  <b>Body nuts and other metal part/Corpo ghiera e altre parti metalliche:</b> <b>0583</b>          Brass/Ottone  <b>Contacts/Contatti:</b>          CuBe  <b>Insulator/Isolante:</b>          PTFE  <b>Gaskets/Guarnizioni:</b>          Silicone Rubber/Gomma Siliconica  <b>Finishing/Finiture</b>  <b>Body/Corpo:</b>          Ag 5µm min.  <b>Contacts/Contatti:</b>          Ag 5µm min.</p>
---	--

**90° - 13/30 FEMALE/FEMMINA - 13/30 FEMALE/FEMMINA**

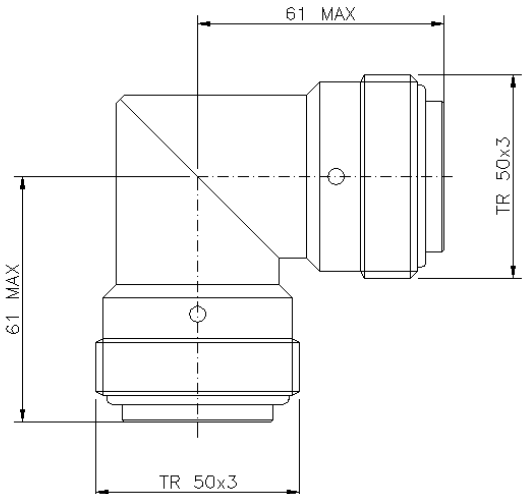
	<p><b>Materials/Materiali</b> <b>BELCO P/N</b>  <b>Body nuts and other metal part/Corpo ghiera e altre parti metalliche:</b> <b>0582</b>          Brass/Ottone  <b>Contacts/Contatti:</b>          CuBe  <b>Insulator/Isolante:</b>          PTFE  <b>Gaskets/Guarnizioni:</b>          Silicone Rubber/Gomma Siliconica  <b>Finishing/Finiture</b>  <b>Body/Corpo:</b>          Ag 5µm min.  <b>Contacts/Contatti:</b>          Ag 5µm min.</p>
--	--

## 13/30 MALE/MASCHIO - EIA 1"-5/8

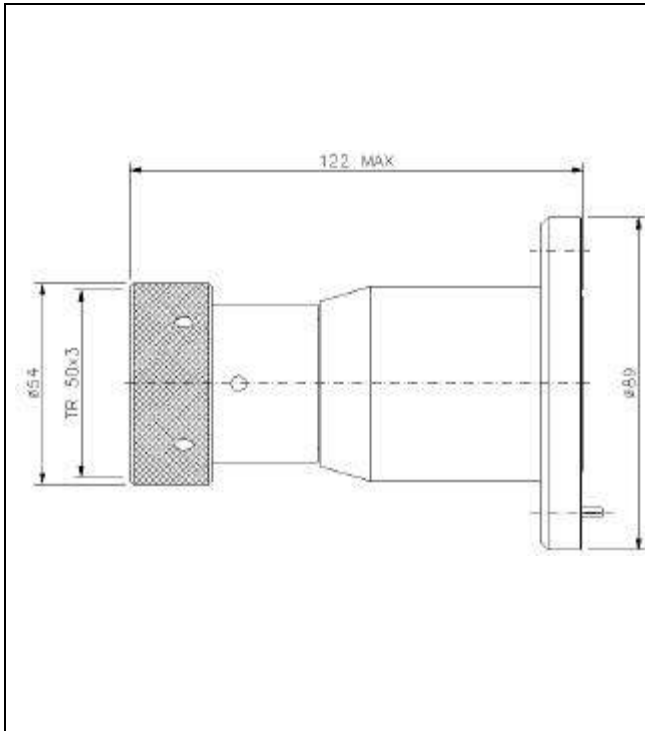
**Materials/Materiali****BELCO P/N**

**Body nuts and other metal part/Corpo ghiera e altre parti metalliche:**

0585

Brass/Ottone

**1-5/8 Contact /Contatto 1-5/8:**

Brass/Ottone

**Male 13/30 Contact/ Contatto Maschio 13/30:**

Brass/Ottone

**Insulator/Isolante:**

PTFE

**Gaskets/Guarnizioni:**

Silicone Rubber/Gomma Siliconica

**Finishing/Finiture****Body/Corpo:**

Ag 5µm min.

**Contacts/Contatti:**

Ag 5µm min.

**Other metallic parts/Altre parti****metalliche:** Ni 5µm min.

## 13/30 FEMALE/FEMMINA - EIA 1"-5/8

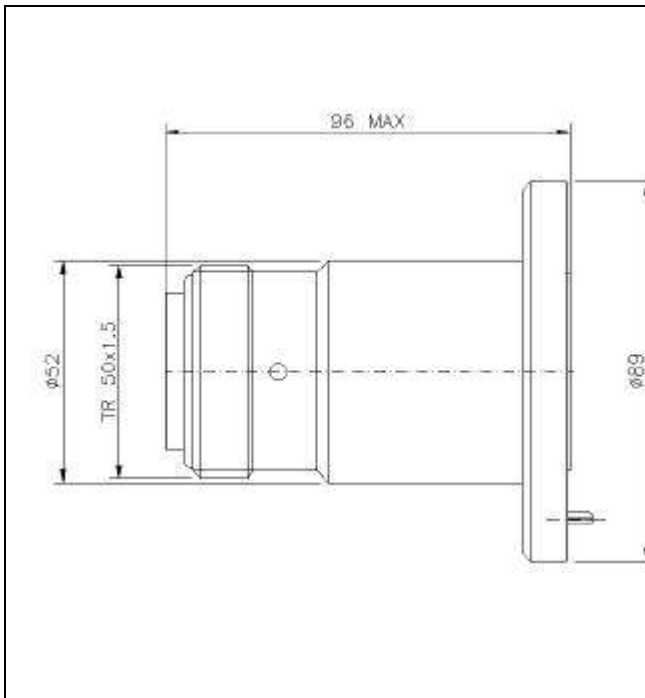
**Materials/Materiali****BELCO P/N**

**Body nuts and other metal part/Corpo ghiera e altre parti metalliche:**

0586

Brass/Ottone

**13/30 Contact/Contatto 13/30:**

CuBe

**1-5/8 Contact/ Contatto 1-5/8:**

Brass/Ottone

**Insulator/Isolante:**

PTFE

**Gaskets/Guarnizioni:**

Silicone Rubber/Gomma Siliconica

**Finishing/Finiture****Body/Corpo:**

Ag 5µm min.

**Contacts/Contatti:**

Ag 5µm min.

**Other metallic parts/Altre parti****metalliche:** Ni 5µm min.

## EIA 7/8" - EIA 7/8" DOPPIA FLANGIA CON INNER

	<p><b>Materials/Materiali</b> <b>BELCO P/N</b> <b>0115</b></p> <p><b>Body nuts and other metal part/Corpo ghiera e altre parti metalliche:</b> Brass/Ottone</p> <p><b>Coupling elements/Elementi di accoppiamento:</b> Brass/Ottone</p> <p><b>Insulator/Isolante:</b> PTFE</p> <p><b>Gaskets/Guarnizioni:</b> Silicone Rubber/Gomma Siliconica</p> <p><b>Finishing/Finiture</b></p> <p><b>Body/Corpo:</b> Ag 5µm min.</p> <p><b>Contacts/Contatti:</b> Ag 5µm min.</p> <p><b>Other metallic parts/Altre parti metalliche:</b> Ni 5µm min.</p>
--	---

## 90° EIA 1"-5/8 - EIA 1"-5/8

	<p><b>Materials/Materiali</b> <b>BELCO P/N</b> <b>0417</b></p> <p><b>Body nuts and other metal part/Corpo ghiera e altre parti metalliche:</b> Brass/Ottone</p> <p><b>7/8 Contact/Contatto 7/8:</b> Brass/Ottone</p> <p><b>Insulator/Isolante:</b> PTFE</p> <p><b>Gaskets/Guarnizioni:</b> Silicone Rubber/Gomma Siliconica</p> <p><b>Finishing/Finiture</b></p> <p><b>Body/Corpo:</b> Ag 5µm min.</p> <p><b>Contacts/Contatti:</b> Ag 5µm min.</p> <p><b>Other metallic parts/Altre parti metalliche:</b> Ni 5µm min.</p>
--	--

## 90° EIA 7/8" - EIA 7/8"

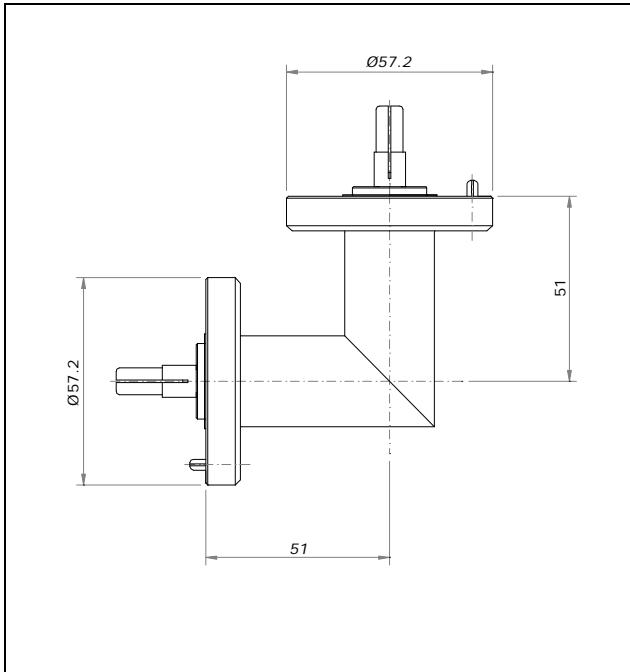

**Materials/Materiali**  
**Body nuts and other metal part/Corpo ghiera e altre parti metalliche:**

Brass/Ottone

**7/8 Contact/Contatto 7/8:**

Brass/Ottone

**Insulator/Isolante:**

PTFE

**Gaskets/Guarnizioni:**

Silicone Rubber/Gomma Siliconica

**Finishing/Finiture**

**Body/Corpo:**

Ag 5µm min.

**Contacts/Contatti:**

Ag 5µm min.

**Other metallic parts/Altre parti metalliche:** Ni 5µm min.

**BELCO P/N**  
**8417**

## 90° EIA 1"-5/8" - EIA 1"-5/8"

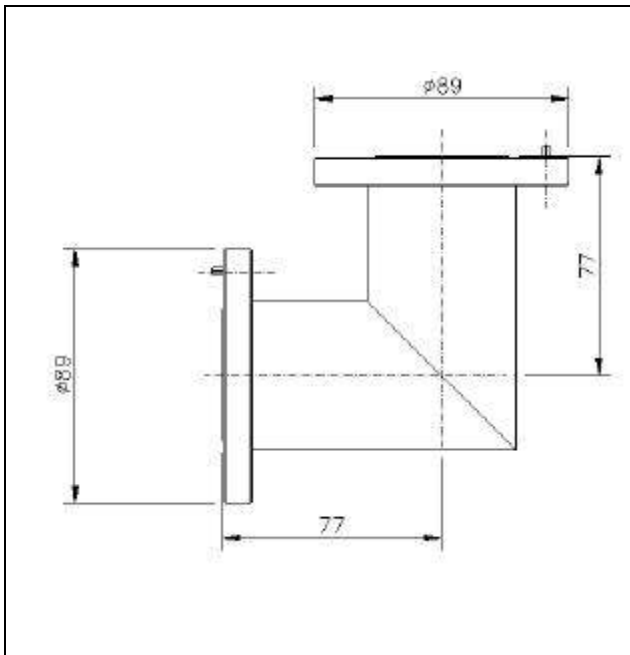

**Materials/Materiali**

**Body nuts and other metal part/Corpo ghiera e altre parti metalliche:**

Brass/Ottone

**1-5/8 Contact/Contatto 1-5/8:**

Brass/Ottone

**Insulator/Isolante:**

PTFE

**Gaskets/Guarnizioni:**

Silicone Rubber/Gomma Siliconica

**Finishing/Finiture**

**Body/Corpo:**

Ag 5µm min.

**Contacts/Contatti:**

Ag 5µm min.

**Other metallic parts/Altre parti metalliche:** Ni 5µm min.

**BELCO P/N**  
**0217**